

**GENERAL NOTES**  
 This document is the property of the FC Holm Architects CC and may not be reproduced, issued or used for any other than the specific purpose for which it was originally intended.  
 All materials and construction methods must comply with the National Building Regulations (act no. 103 of 1977) including all amendments, as well as all by-laws of the relevant local authority.  
 All materials and equipment must be fixed and finished off in accordance with the specifications of the manufacturer of such materials and equipment.  
 All dimensions must be checked on site. Any inconsistencies or discrepancies must be pointed out to the principal agent for rectification or clarification before work is taken into hand.  
 Never scale from this drawing.

**NOTES**  
 Refer to the general specifications for material and methods for this project

APPROVED BY  
 REGISTERED LAND SURVEYOR  
 J.H. BAILEY  
 PLS 0019D

**REVISIONS**

REV. NO.	DATE	DESCRIPTION



044 874 1606  
 info@fcholm.co.za  
 PO Box 9457  
 GEORGE  
 6530

**MONTE CRISTO  
 RETIREMENT VILLAGE  
 DE CARAVEL  
 CLUBHOUSE AND CARING**

<b>ROOF PLAN</b>	
scale 1:200	drawn ij
date 20/11/2023	checked fch
drawing no. 23015/S/3105	revision 001

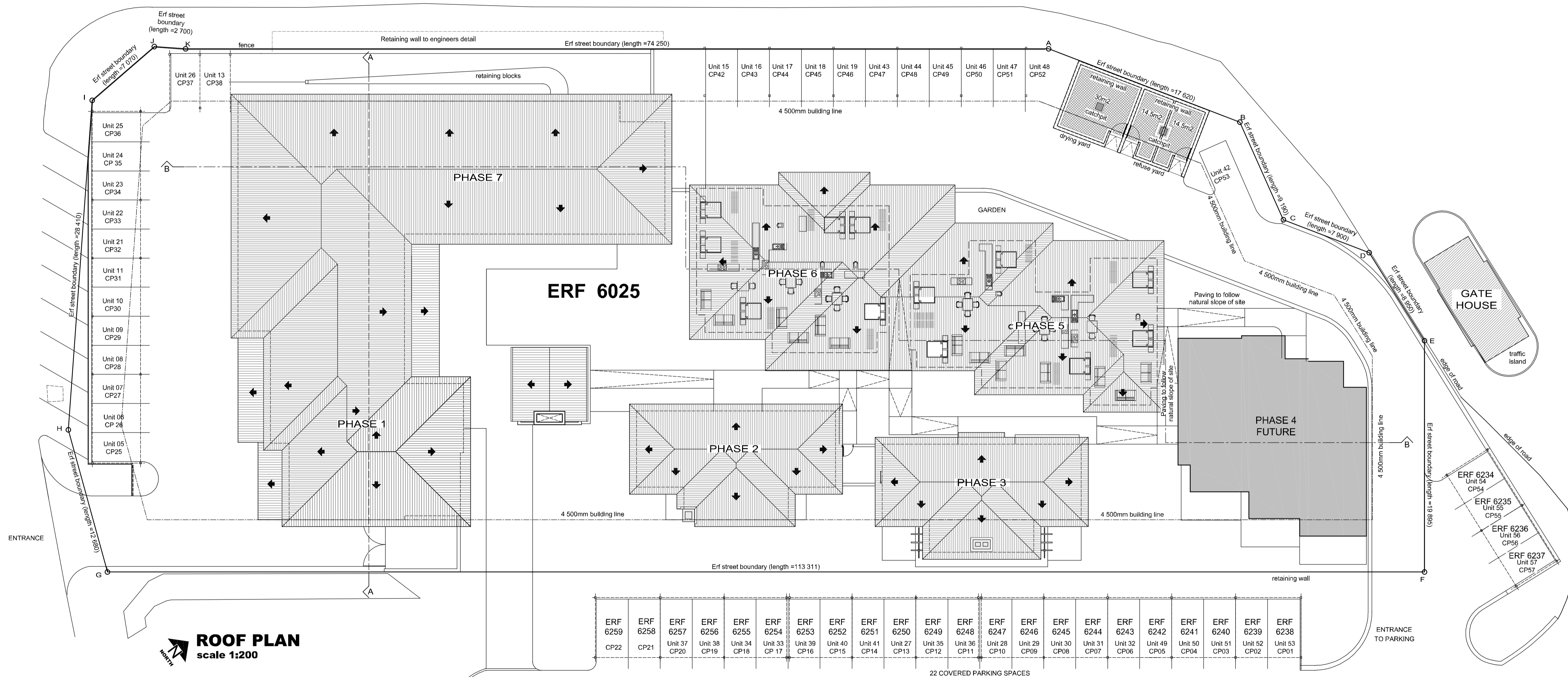

**ROOF PLAN**  
 scale 1:200